

Setup Screen Share on AVer's interactive flat panel with Android devices

AVer IFP

1

Setup the Wi-Fi network connection.

2

Make sure AVer's interactive flat panel and the sharing device are on the same network.

3

Launch the **Screen Share** app.

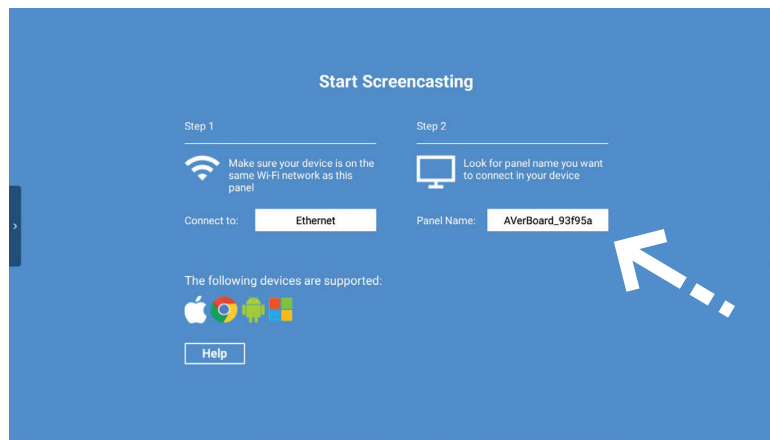

Android Phone / Android Tablet

1

Open **Settings**.

2

Under Wireless & Networks, select **Play To**.

3

Select **AVerBoard** from the list.

